

REV.	ECN NO.	DESCRIPTION	DRAW	APPD.	DATE
A	---				

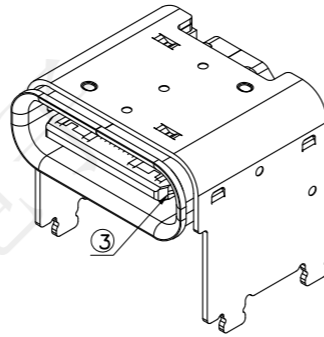

NOTE:

- MATERIAL SPECIFICATION:
  - HOUSING: HIGH TEMPERATURE RESISTANT PLASTIC, UL94 V-0.
  - CONTACTS: COPPER ALLOY
  - MID PLATE: STAINLESS STEEL
  - INSIDE SHELL: STAINLESS STEEL
  - OUTSIDE SHELL: STAINLESS STEEL
- PLATING SPECIFICATION:
  - CONTACTS:
    - Ni 50u" MIN. UNDER PLATED OVER ALL.
    - Au PLATED ON THE FUNCTIONAL AREA OF CONTACT. (GOLD PLATING THICKNESS FOLLOW THE P/N) GOLD FLASH PLATING ON SOLDER AREA
  - INSIDE SHELL OR OUTSIDE SHELL:
    - Ni 30u" MIN. UNDER PLATED OVER ALL.
- MECHANICAL PERFORMANCE,
  - INSERTION FORCE: 0.5~2.0kgf.
  - REMOVAL FORCE: 0.8kgf~2.0kgf.
  - DURABILITY: 10000 CYCLES.
- ELECTRICAL PERFORMANCE,
  - CURRENT RATING: 5A  
VOLTAGE RATING: 20V
  - INSULATION RESISTANCE: 100MΩ MIN
  - DIELECTRIC WITHSTAND VOLTAGE, AC 100V FOR 1 MINUTE.
  - LOW CONTACT RESISTANCE: INITIAL 40MΩ  
AFTER 50MΩ
- ENVIRONMENTAL PERFORMANCE:
  - OPERATING TEMPERATURE: -30°C~+80°C.
- IR REFLOW:
  - THE PEAK TEMPERATURE ON THE BOARD SHALL BE MAINTAINED FOR 10 SECONDS AT 260°C.

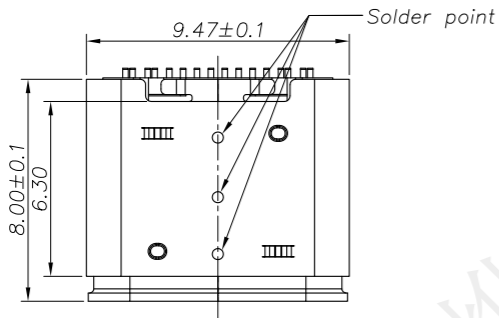
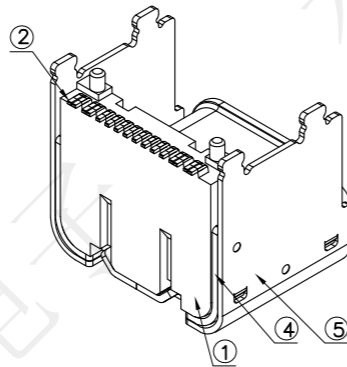
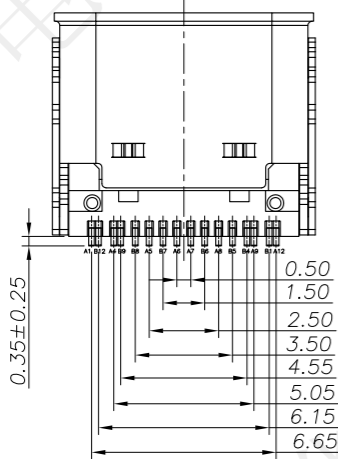
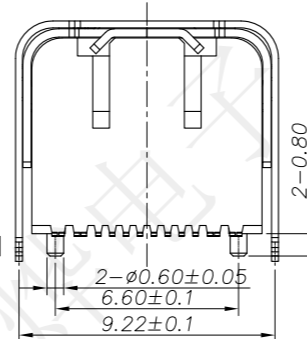
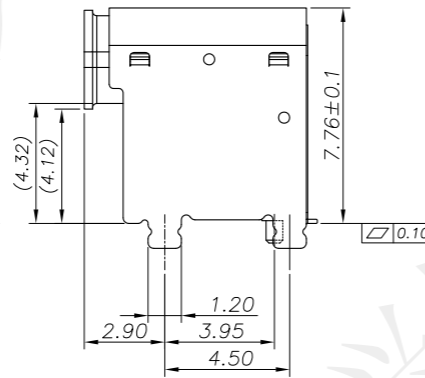
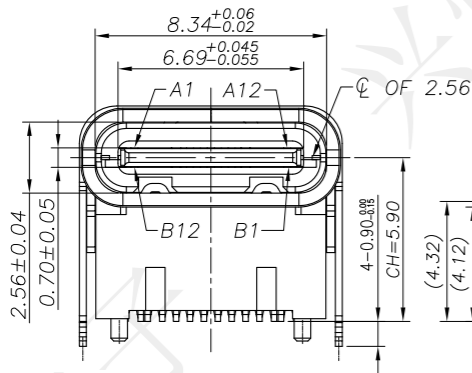

受控文件

5	OUTER SHELL	SUS304 T=0.25MM	NI 30u"MIN	1PCS
4	INNER SHELL	SUS304 T=0.30MM	NI 30u"MIN	1PCS
3	SHIELDING PLATE	SUS301 T=0.15MM	N/A	1PCS
2	CONTACT	C2680 T=0.15MM	Mating area 1u"Au Solder Tails: G/F Underplate: 50u"Min Ni overall	2SET
1	INSERT MOLDING	LCP UL94V-0	BLACK	1PCS
NO.	DESCRIPTION	MATERIAL	REMARKS	

		Series Name :	
		Product Name :	
TOLERANCE		TYPE-CF-16P双外壳板上四脚插L8.0垫高4.3 CH5.9	
X.X ±0.30	X.° ±2°	Part NO: UCB27550	
XX ±0.20	X.° ±1°	SCALE SHEET REV.	
XXX ±0.10	XX.° ±0.5°	1:1	1/1 A1
UNITS	mm	DRAW: 马洪飞	

REV.	ECN NO.	DESCRIPTION	DRAW	APPD.	DATE
A	---				

USB TYPE-C PIN ASSIGNMENTS

PIN NUMBER	SIGNAL NAME	PIN NUMBER	SIGNAL NAME
A1	GND	B12	GND
A4	VBUS	B9	VBUS
A5	CC1	B8	SBU2
A6	Dp1	B7	Dn2
A7	Dn1	B6	Dp2
A8	SBU1	B5	CC2
A9	VBUS	B4	VBUS
A12	GND	B1	GND

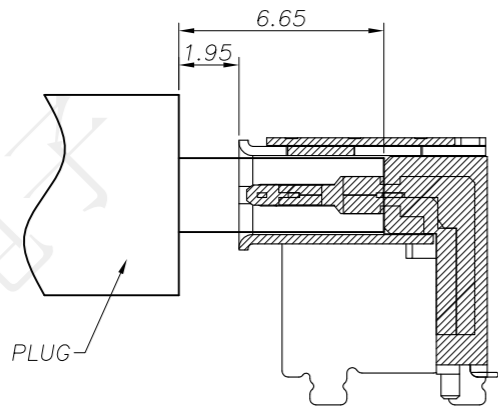

AFTER MATING  
SCALE 1:1

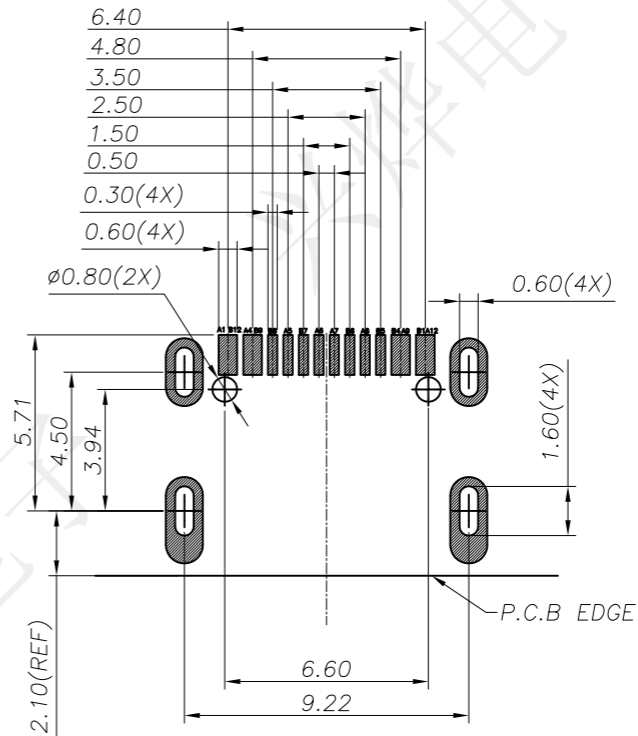

RECOMMEND P.C.B LAYOUT(COMPONENT SIDE)  
TOLERANCE FOR PCB LAYOUT IS  $\pm 0.05$

受控文件

 <b>深圳市兴烨电子有限公司</b> Shenzhen XingYe Electronics co., Ltd		Series Name :	
<b>TOLERANCE</b> X.X $\pm 0.30$ X. $^{\circ}$ $\pm 2^{\circ}$ .XX $\pm 0.20$ X. $^{\circ}$ $\pm 1^{\circ}$ .XXX $\pm 0.10$ XX. $^{\circ}$ $\pm 0.5^{\circ}$ UNITS mm		Product Name : TYPE-CF-16P双外壳板上四脚插L8.0垫高4.3 CH5.9	
APPD: 陈爱光 CHED: 施立敏 DRAW: 马洪飞		Part NO: UCB27550	
		 SCALE 1:1	SHEET 1/1
		REV. A1	

REV.	ECN NO.	DESCRIPTION	DRAW	APPD.	DATE
A	---				

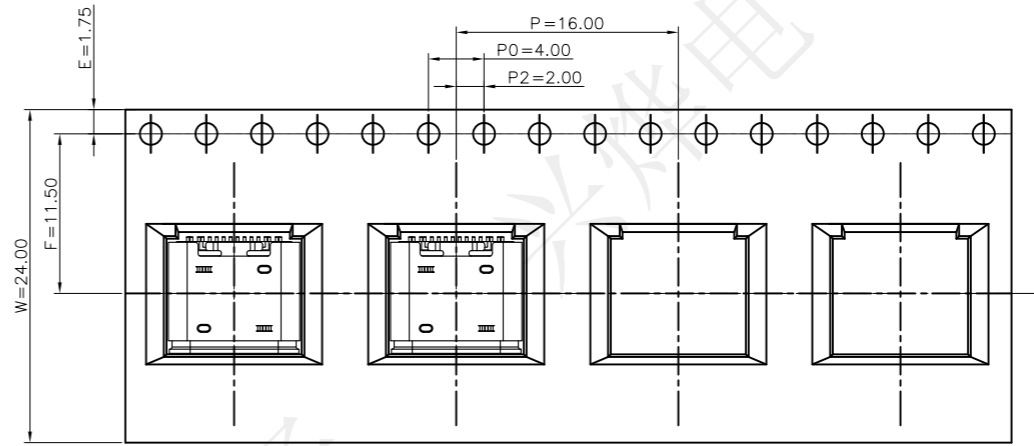
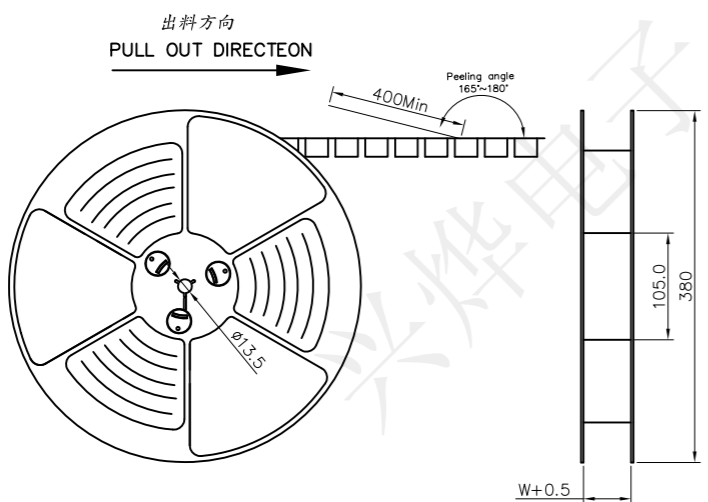

**NOTES**

1. 帶子引導長度  
LEAD TAPE LENGTH

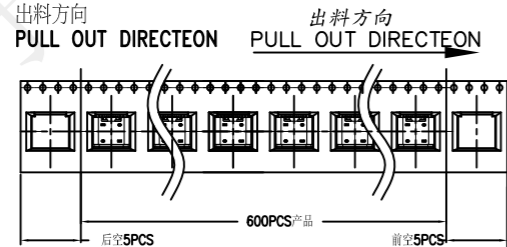

2. 上帶 剝離力為：0.1~1.3N(10.2gf~130gf)  
PEELING OFF FORCE OF TOP TAPE:0.1~1.3N(10.2gf~130gf)  
出貨運輸過程中一定注意：  
THIS REQUIREMENT SHOULD BE APPLIED AT SHIPMENT：  
卷帶在運輸過程中不能散開  
PEELING OFF SHOULD NOT BE ALLOWED DURING TRANSPORTATION

TAPE & REEL 7 PCS

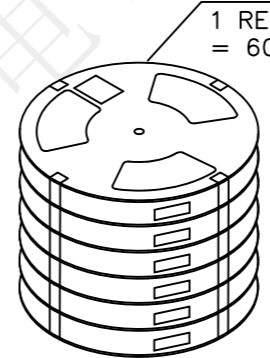

1 REEL  
= 600 PCS

BOX

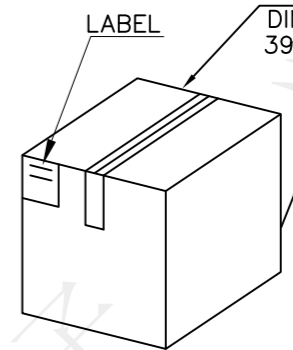

DIMENSIONS:  
39.5X39.5X20

1 CARTON  
= 6 RFFLS

受控文件



包裝明細表 (The detail of the packing) Carton					
包裝容量 (Packing Capacity)			重量 Weight (Kg)		
pcs/box	boxes/Carton	Pcs/Box	N.W./Pcs	N.W./Box	G.W./Box
600	6	3600	—	—	—

		Series Name :	
		Product Name :	
TOLERANCE		APPD: 陈爱光	
X.X ±0.30	X° ±2°	CHED: 施立敏	
.XX ±0.20	.X° ±1°	DRAW: 马洪飞	
.XXX ±0.10	.XX° ±0.5°		
UNITS	mm		

TYPE-CF-16P 双外壳板上四脚插L8.0 垫高4.3 CH5.9		
Part NO: UCB27550		
SCALE	SHEET	REV.
1:1	1/1	A1