

REV.	ECN NO.	DESCRIPTION	DRAW	APPD.	DATE
A	---				

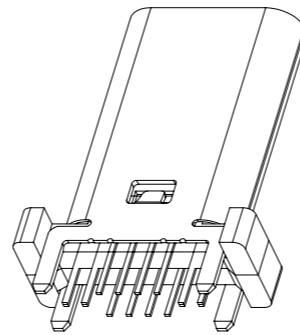

- MECHANICAL PERFORMANCE,
  - INSERTION FORCE: 5-20N
  - REMOVAL FORCE: 8-20N
  - DURABILITY: 10000 CYCLES.
- ELECTRICAL PERFORMANCE,
  - CURRENT RATING: 5A  
VOLTAGE RATING: 20V
  - INSULATION RESISTANCE: 100MΩ MIN
  - DIELECTRIC WITHSTAND VOLTAGE, AC 150V FOR 1 MINUTE.
- ENVIRONMENTAL PERFORMANCE:  
OPERATING TEMPERATURE: -40° C~+85° C.
- IR REFLOW:  
THE PEAK TEMPERATURE ON THE BOARD SHALL BE MAINTAINED FOR 10 SECONDS AT 260° C.

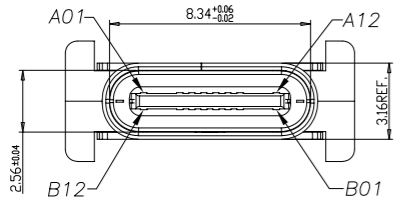
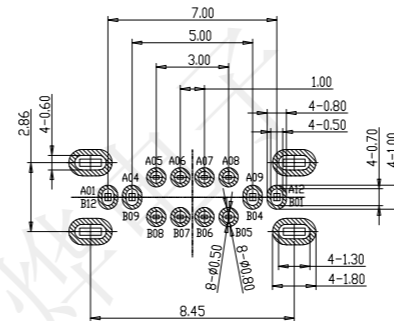
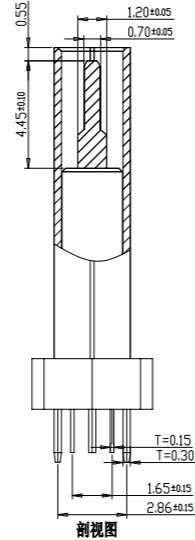
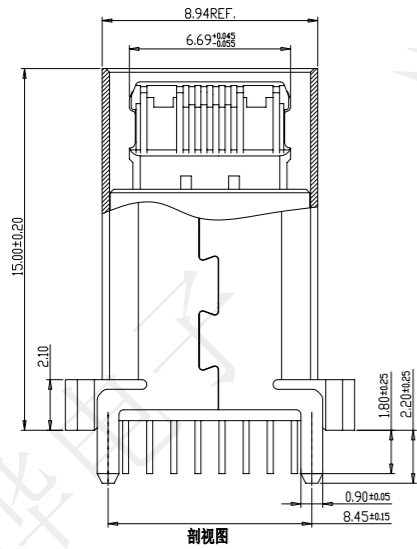

RECOMMENDED P.C.B. LAYOUT (俯视图)  
TOLERANCE UNSPECIFIED ±0.05mm

受控文件

A1	GND	B12	GND
A4	VBUS	B9	VBUS
A5	CC1	B8	SBU2
A6	DP1	B7	DN2
A7	DN1	B6	DP2
A8	SBU1	B5	CC2
A9	VBUS	B4	VBUS
A12	GND	B1	GND
PIN	SIGNAL NAME	PIN	SIGNAL NAME

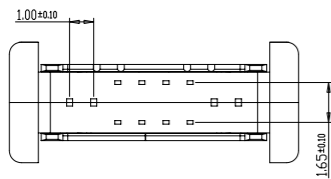

4	Front shell	SUS304	Ni/SN plated
3	Mid plate	SUS304	
2	Contact	C7025	Au/Ni plated
1	Housing	LCP/PA9T	Black UL94V-0
NO.	Part name	Material	Remarks

深圳市兴烨电子有限公司  
ShenZhen XingYe Electronics co., Ltd

TOLERANCE		
X.X	±0.30	X.° ±2°
.XX	±0.20	X.° ±1°
.XXX	±0.10	XX.° ±0.5°
UNITS	mm	

APPD: 陈爱光  
CHED: 施立敏  
DRAW: 马洪飞

Series Name:		
Product Name: TYPE-CF-16P直插H15.0加盖编带		
Part NO: UCY27615		
	SCALE 1:1	SHEET 1/1
	REV. A1	