

REV.	ECN NO.	DESCRIPTION	DRAW	APPD.	DATE
A	---				

1	VBUS
2	D-
3	D+
4	GND
5	StdB_SSTX-
6	StdB_SSTX+
7	GND_DRAIN
8	StdB_SSRX-
9	StdB_SSRX+
PIN	SIGNAL NAME

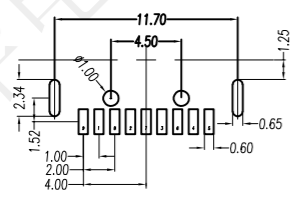

RECOMMENDED P.C.B LAYOUT

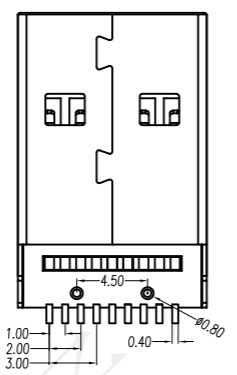
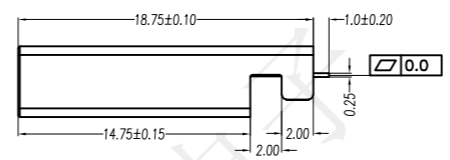
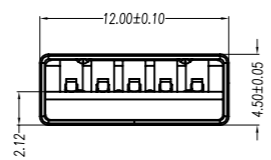
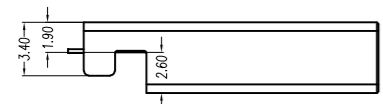
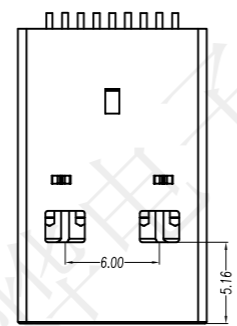
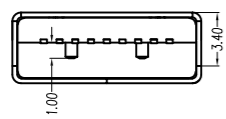

受控文件

Specification:
 Current rating: DC 1.5A 30V
 Dielectric withstanding voltage: 500 V(ac) for 1 min.
 Contact resistance: 30 mΩ Max.
 Insulation resistance: 100 MΩ Min.
 Total mating force: 3.57 Kgf Max.
 Total unmating force: 1.02 Kgf Min.
 Temperature range: -30°C~80°C

3	Shell	1PCS	copper alloy C2680/SPCC	t=0.3mm
2	Contacts	9 PCS	copper alloy C2680	t=0.25mm
1	Housing	1PCS	LCP	BLUE /UL94V-0
No.	Pare Name	Number	Material	Remarks

深圳市兴烨电子有限公司 ShenZhen XingYe Electronics co., Ltd		Series Name :		
TOLERANCE		Product Name :		
X.X ±0.30	X.° ±2°	A公3.0沉板2.6有柱直脚L18.7		
.XX ±0.20	.X° ±1°	Part NO: USBL48032		
.XXX ±0.10	.XX° ±0.5°	SCALE SHEET REV.		
UNITS mm	APPD: 陈爱光	1:1 1/1 A1		
	CHED: 施立敏			
	DRAW: 马洪飞			