

REV.	ECN NO.	DESCRIPTION	DRAW	APPD	DATE
	---				

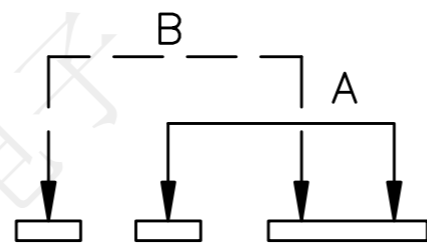

CIRCUIT

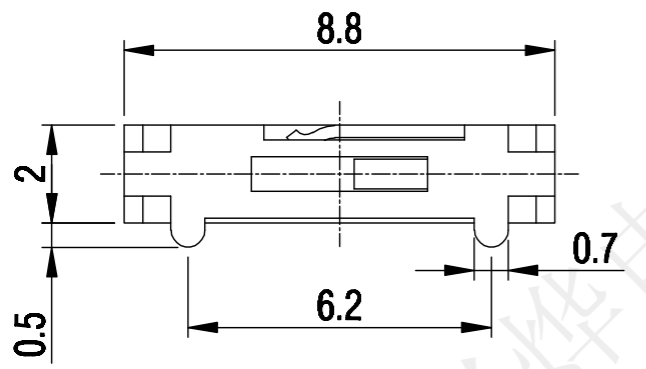
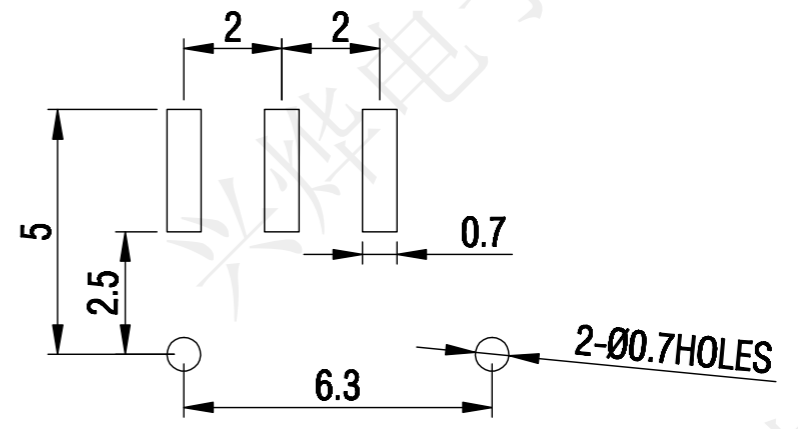

P.C.B LAYOUT DIMENSION

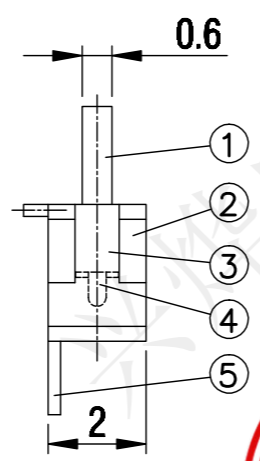
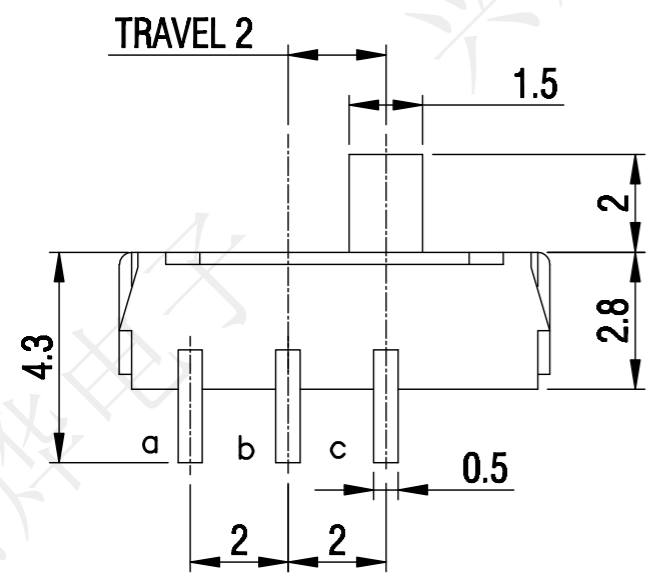

**SPECIFICATION:**  
 Operating temperature: -16 °C~60°C  
 Rated loading: DC 12V 0.1A  
 Contact resistance: 30mΩ Max  
 Insulation resistance: 100MΩ Min  
 Withstanding voltage: AC 500V (50-60Hz) /min  
 Operation Force: 150gf+50gf  
 Electrical Life: 10,000 cycles



**受控文件**

5	TERMINAL a,b&c	C2680	3	Ag
4	CONTACT	C5210	1	Ag
3	COVER	SUS	1	NATURAL
2	BOTTOM	PA46	1	BLACK
1	STEM	PA46	1	BLACK
NO.	PARTS	MATERIAL	QTY.	FINISHING

**深圳市兴烨电子有限公司**  
 ShenZhen Xing Ye Electronics co., Ltd

TOLERANCE		APPD: 陈爱光 CHED: 施立敏 DRAW: 马洪飞
X.X ±0.30	X° ±2°	
.XX ±0.20	.X° ±1°	
.XXX ±0.10	.XX° ±0.5°	
UNITS	mm	

Series Name :		
Product Name : MSK-12D18A H2.0偏三脚立式带定位		
Part NO: SKL10007		
SCALE	SHEET	REV.
1:1	1/1	A1