

REV.	ECN NO.	DESCRIPTION	DRAW	APPD.	DATE
A	---				

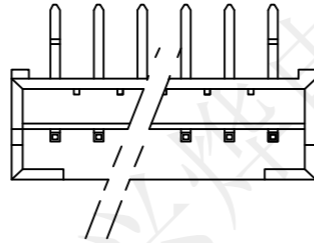

Operating temperature:-25℃~85℃
 Rated loading:2A 250V AC,DC
 Contact resistance:10mΩ Max
 Insulation resistance:1000MΩ Min
 Withstanding voltage:AC 800V (50HZ)/min
 Material: PA66 FV2
 插针: 黄铜
 Applicable Wires:AWG 28#~22#
 Applicable PCboard thickness>0.8mm~1.6mm

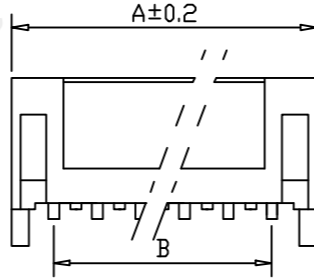
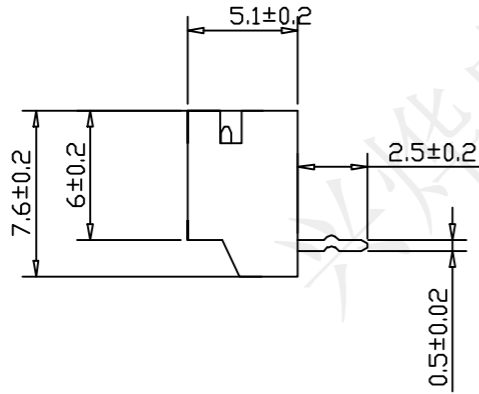

受控文件

PIN数	料号	尺寸	
		A	B
2P	CZB15424	6.00	2.00
3P	CZB15425	8.00	4.00
4P	CZB15426	10.00	6.00
5P	CZB15427	12.00	8.00
6P	CZB15428	14.00	10.00
7P	CZB15429	16.00	12.00
8P	CZB15430	18.00	14.00
9P	CZB15431	20.00	16.00
10P	CZB15432	22.00	18.00
11P	CZB15433	24.00	20.00
12P	CZB15434	26.00	22.00
13P	CZB15435	28.00	24.00
14P	CZB15436	30.00	26.00
15P	CZB15437	32.00	28.00

深圳市兴烨电子有限公司
 Shenzhen XingYe Electronics co., Ltd

TOLERANCE		
.X.X ±0.30	X.° ±2°	APPD: 陈爱光
.XX ±0.20	.X° ±1°	CHEd: 施立敏
.XXX ±0.10	XX° ±0.5°	DRAW: 马洪飞
UNITS	mm	

Series Name : PH-nAWD带定位米黄色

Product Name :

Part NO:

	SCALE	SHEET	REV.
	1:1	1/1	A1