

REV.	ECN NO.	DESCRIPTION	DRAW	APPD.	DATE
A	---				

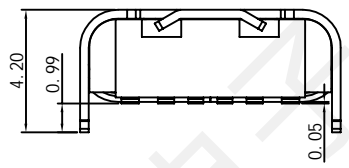

- MECHANICAL PERFORMANCE
  - INSERTION FORCE: 0.5~2.0kgf.
  - REMOVAL FORCE: 0.8kgf~2.0kgf.
  - DURABILITY: 5000 CYCLES.
- ELECTRICAL PERFORMANCE
  - CURRENT RATING: 3.0A  
VOLTAGE RATING: 5.0V
  - LLCR: VBUS & GND PINS AND OTHER PINS: 40mΩ/PIN MAX.  
SHIELD: 50mΩ/MAX.  
LLCR MAX. CHANGE OF ALL PINS: 10mΩ.
  - INSULATION RESISTANCE: 100MΩ MIN
  - DIELECTRIC WITHSTAND VOLTAGE, AC 100V FOR 1 MINUTE.
- ENVIRONMENTAL PERFORMANCE: OPERATING TEMPERATURE: -25°C~+85°C.
- IR REFLOW: THE PEAK TEMPERATURE ON THE BOARD SHALL BE MAINTAINED FOR 10 SECONDS AT 260°C.

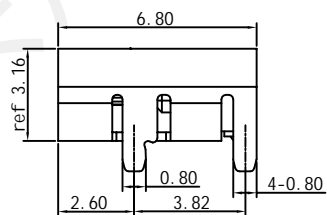
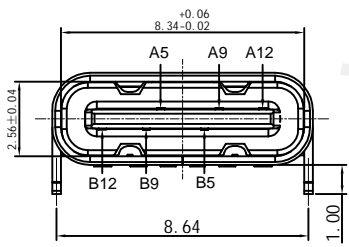
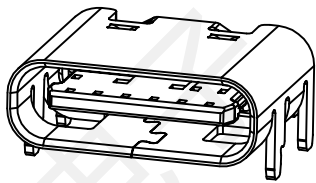
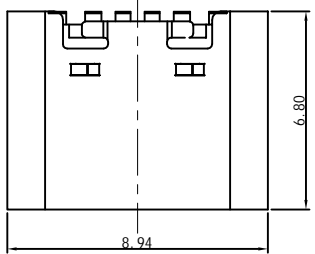
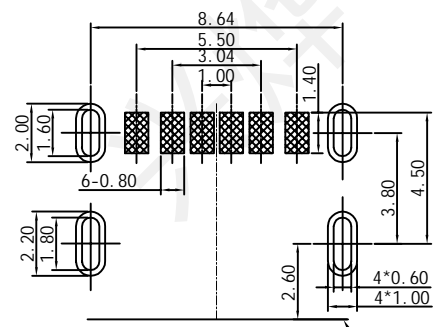
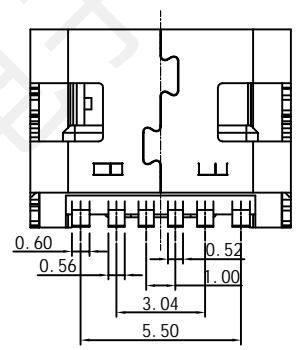

RECOMMENDED P.C.B. LAYOUT  
TOLERANCE UNSPECIFIED ±0.05mm

受控文件



PIN ASSIGNMENTS			
PIN	SIGNAL NAME	PIN	SIGNAL NAME
A5	CC1	B12	GND
A9	VBUS	B9	VBUS
A12	GND	B5	CC2

NO.	Part name	Material	Remarks
4	Front shell	SUS201	Ni/SN plated
3	Mid plate	SUS301	
2	Contact	Copper alloy	Au/Ni plated
1	Housing	LCP	Black

		TOLERANCE	
		X.X ±0.30	X° ±2°
.XX ±0.20	.X° ±1°	APPD: 陈爱光	
.XXX ±0.10	.XX° ±0.5°	CHED: 施立敏	
UNITS	mm	DRAW: 马洪飞	

Series Name :			
Product Name :			
TYPE-CF-6P板上四脚插L6.8黄铜SUS201			
Part NO:		UCZ27425	
SCALE	SHEET	REV.	
1:1	1/1	A1	